

名称:纳拓多功能头灯说明书
尺寸:80x50mm (成品) 160x300mm (展开)
颜色:PANTONE COOL GRAY 10C
工艺:先左右对折再风琴折页做压痕
材质:105克双铜纸
日期:2022/8/26

NexTool

纳拓多功能头灯使用说明书

使用产品前请仔细阅读本说明书,并妥善保管
适用型号:NE20002, NE20003

产品特点

1. 轻便型多功能组合灯,一灯多用——头灯,小营灯。
2. COB泛光光源,视觉更舒适柔和。
3. 白光+红光,照明+警示双体验。
4. Type-C直充设计,节能环保。
5. 一键操作,档位轻松切换。

性能参数

实测光电参数	4种发光模式			
	白光高亮	白光低亮	红光常亮	红光频闪
亮度	170流明	20流明	5流明	—
续航时间	2小时	11小时	18小时	—
最远射程	19米	7米	—	—

防跌高度	1米
防水等级	IPX4
光源	COB
规格	61毫米(长) × 46毫米(宽) × 19毫米(高)
重量	37.8克(灯体)
材料	头灯: ABS塑料; 头灯带: 涤纶
充电	充放电功能; Type-C直充, 充满电时间2.5±0.5小时
电池	内置640mAh锂电池

上述参数严格按照Q/GDBCY 015-2019标准, 测试电池为10440×2 (640mAh) 锂离子电池, 如测试环境不同, 性能参数可能会有差异。

操作说明

操作
长按1秒开启白光, 短按切换白光高亮、低亮; 长按3秒开启红光, 短按切换红光常亮、频闪; 长按1秒关闭

电量指示
使用过程中, 电量高于70%时, 指示灯为绿色; 电量为30%-70%时, 指示灯为橙色; 电量低于30%时, 指示灯为红色

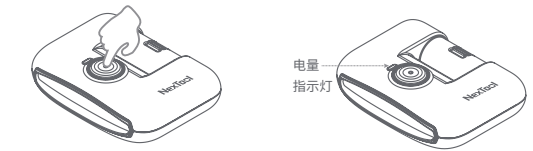

充电
充电时红灯常亮, 满电时绿灯常亮; 使用标准5V /1A适配器, 充电时间2.5±0.5小时

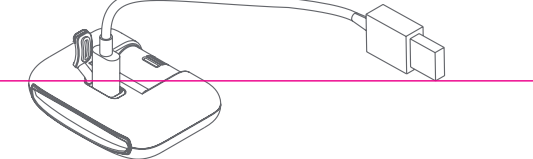

内含组件

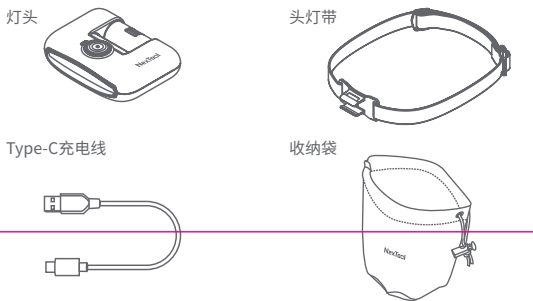

安装说明

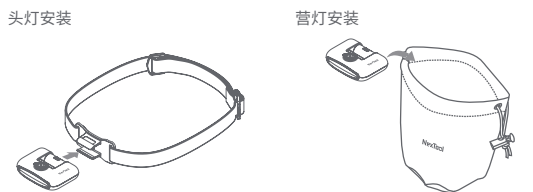

注意事项

1. 注意每次户外使用后, 及时清洁产品, 防止污垢或腐蚀性液体影响产品使用寿命;
2. 本品电池包含锂离子电芯, 严禁私自拆开电池外壳, 避免可能造成的电芯破损或其他危险;
3. 严禁任意拆解、挤压、穿刺、短路本产品、投入火中或暴露于温度高于60°C的环境中;
4. 由于高亮档位光线较高, 请勿给儿童玩耍及直接对人眼照射, 以免对眼睛造成伤害。

保修条款

本保修政策是制造商(“我们”)向最终用户(“您”)提供保修和其他相关事宜的法律文件, 请您妥善保管。如您在购买产品时销售商或其他第三方声明将由其提供保修服务或其他更多服务的, 则保修服务或 其他服务将由销售商或第三方提供。

一、说明

本保修服务仅适用于符合出厂配置的产品或其部件在保修期内经正常使用后出现保修范围内的性能故障。保修范围内性能故障的界定, 如国家有相关规定、依据国家规定; 如无规定, 将由我们依据本保修政策判定。

二、保修期

保修期自产品交付之日起算一年。网络、电话或其他非现场交易的交付日以第三方物流记载的交付时间为交付日; 其他情形则以发票日为交付日, 但如您确能有效证明非因您的原因导致发票日早于实际交付日的, 经我们确认无异议后可以实际交付日为准。如您无法提供有效的第三方物流交付信息或发票的, 则保修日自产品出厂后三十日起算。 具体保修期限和其他事宜, 请同步见保修卡。

三、服务获取和配合

您可以按照如下方式联系我们以获取保修服务:

- A. 致电: 0662 - 369 2722;
 - B. 联系您实际购买时的销售平台。
- 申请保修时, 您应提供清晰、完整和准确的①产品发票; ②保修卡; ③电商平台订单信息(如有); 如因您无法提供而不能确认产品来源的, 您将无法获取保修服务。

四、保修政策

1. 自保修期起始后 7 日内, 产品出现性能故障, 经由我们或我们授权的售后服务中心检测确定, 可免费享受退货或换货服务。换货的, 保修期将重新计算。
2. 自保修期起始后8-15日内, 产品出现性能故障, 经由我们或我们授权的售后服务中心检测确定, 可免费享受换货或维修服务。换货的, 保修期将重新计算。
3. 自保修期起始后12个月内, 产品出现性能故障, 经由我们或我们授权的售后服务中心检测确定, 可免费享受维修或更换服务。维修或更换的产品将在原产品在剩余保修期内继续享有保修服务, 剩余保修服务期不足3个月的, 则剩余保修期延至3个月。
4. 退货或换货时, 您需将产品随附物及包装一并完整退还, 并保持产品本身、附随配件、产品外观不存在任何破损、划伤、损坏; 维修的, 维修时新换上的部件归属于您, 旧件将被我们回收。
5. 属于保修范围内的产品硬件故障, 由我们承担物流费用和保修产生的其他费用。经确认不属于保修范围内的故障或损坏的, 除非届时另有规定, 由您承担往返运费(如有)和运输过程中的风险。

五、非保修范围

下列情况将不提供保修:

1. 因误用、意外、改装、私拆、进液等不适当的物理或操作环境、不可抗力、不当维护或保管导致的故障或损坏;
2. 未经我们授权的机构或人员私自拆卸或修理;
3. 产品使用过程中发生的脱色、磨损和消耗;
4. 随产品或部件的相关标签、标识被更改或去除, 如: 保修凭证上产品信息或序列号与实物不相符合, 或有涂改的;
5. 部件有明显的硬物损伤, 伤痕、缺角、严重变形、破损等现象;
6. 产品超出保修期。

六、有偿服务

对于超出保修期或保修服务范围之外的产品故障, 经确认可由我们提供服务的, 我们将提供有偿的专业维修服务, 您知悉并同意维修时旧部件将被回收。除非届时另有明确约定, 我们将对被维修或更换的零部件提供90天的质保期。

七、一般条款

本服务政策适用中国大陆区域的法律(不包括其冲突法)。如因本文件项下的事宜发生任何争议, 友好协商未果的, 将提交阳江市江城区有管辖权的人民法院裁决。)

保修卡

产品信息	品 名		型 号	
用户信息	姓 名		电 话	
	地 址			
销售商信息	名 称		电 话	
	地址 / 网址			
	销售日期		发票号码	

如有售后服务需求, 请联系广东百创源科技股份有限公司客服部门

售后服务电话: 0662 - 369 2722

服务时间: 周一至周五 8:00 - 17:15

制造商: 广东百创源科技股份有限公司

地址: 广东省阳江市江城银铃科技产业园B9-3



纳拓官网



纳拓微信公众号

NexTool

User manual of NexTool Multi-purpose Headlamp

Please read this manual before using and keep it carefully

Applicable model: NE20002, NE20003

FEATURE

1. Portable multi-function lamp(Headlamp/ Small camp lamp).
2. COB floodlight source, more comfortable and soft.
3. Have white light and red light to fulfill lighting and warning need.
4. Type-C charging design, efficient and eco-friendly.
5. One-button control system,easy to change different mode.

PERFORMANCE PARAMETER

Parameter	4 Lighting Modes			
	White High-light	White Low-light	Red	Red Strobe
Lumen	170lm	20lm	5lm	-
Run Time	2hrs	11hrs	18hrs	-
Beam Distance	19m	7m	-	-
Drop Height	1m			
Water Resistance	IPX4			
Light Source Type	COB			
Dimension	61mm(L) × 46mm(W) × 19mm(H)			
Weight	37.8g(Lamp body)			
Material	Headlamp: ABS plastic; Headlamp belt: polyester			
Charging	Type-C charge , Charge time : 2.5±0.5 h			
Battery	640mAh lithium battery			

All the above parameters are tested strictly according to Q/GDBCY 015-2019 standards. The tested battery is 10440×2(640mAh) lithium batteries. The performance parameters may vary depending on test battery or environmental conditions.

INSTRUCTIONS

Instruction

Long press for 1S to turn on the white light mode, Quickly press the switch to change white light mode (low-high);
Long press for 3S to turn on the red light mode, Quickly press the switch to change red light mode(red/red strobe);
Long press for 1S to turn off when the lamp is on

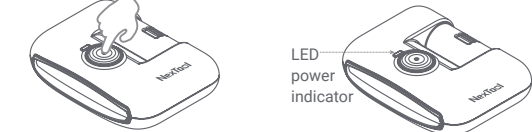

Charge

The red light will on when charging and green light will on when finishing;
Use the 5V/1A adapter charging for 2.5±0.5 hours.

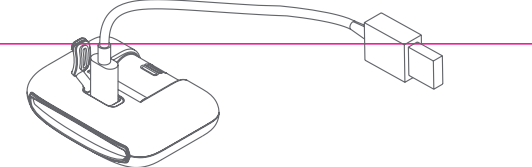

COMPONENTS

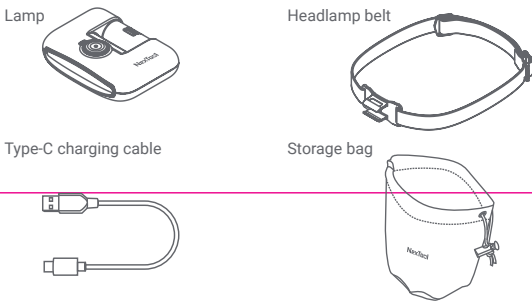

INSTALLATION INSTRUCTIONS

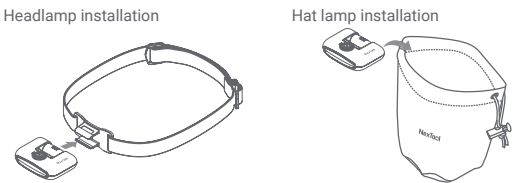

MAINTENANCE

1. Please clean the product in time after each outdoor use to prevent dirt or corrosive liquids from damaging the service life of the product.
2. The battery contains lithium core, it is strictly prohibited to open the battery shell to avoid core damage or other hazards.
3. Any disassembly, extrusion, puncture or short circuit of this product is strictly prohibited. Please do not place the product in environment above 60°C or in fire.
4. The product can emit strong light(high light mode), please do not give children to play or direct human eyes to avoid injure.

WARRANTY

This warranty policy is a legal document we manufacturer provide for our end user, stipulating warranty services and other related matters. Please keep it properly. If the retailer or other third party whom you buy the product from declares that it will provide warranty service or other more services, the warranty service or other services will be provided by the retailer or third party.

1. Instruction

This warranty service is only applicable to the product or its parts that meet the factory configurations during normal use within the warranty period when there is a performance failure within the warranty scope. The definition of performance failures within the warranty scope, if the country has relevant regulations, shall be based on national regulations; if there are no regulations, we will determine it in accordance with this warranty policy.

2. Warranty period

The warranty period is one year from the date of delivery of the product. The delivery date of online, telephone or other off-site transactions is the same as delivery date recorded by the third-party logistics; in other cases, the invoice date should be regarded as delivery date, but if you can effectively prove that the invoice date is earlier than the actual delivery date and it is not caused by your end, the actual delivery date shall prevail with our confirmation. If you are unable to provide valid third-party logistics delivery information or invoices, the warranty date will be calculated from 30 days after the product leaves the factory. Please see the warranty card for the specific warranty period and other matters.

3. How to access to our services

Below optional methods for you to contact us for warranty service:

A. Service hot-line: 86 - 662 - 369 2722

B. Contact the selling platform where you buy the product.

For warranty application, please submit clear, complete and correct documents including ① invoice; ② warranty card; ③Order information on E-commerce platform (if applicable).

If you cannot provide above proofs indicating the source of the product, you will not be able to obtain warranty service.

4. Warranty policy

- 1). Within 7 days since the start of the warranty period, if the product has a performance failure, and it is confirmed by us or our authorized after-sales service center, you can enjoy the return or replacement service for free. For replacement product, the warranty period will be recalculated.
- 2). Within 8-15 days since the start of the warranty period, if the product has a performance enjoy failure, and it is confirmed by us or our authorized after-sales service center, you can free replacement or repair services. For replacement product, the warranty period will be recalculated.
- 3). Within 12 months since the start of the warranty period, if the product has a performance failure, and it is confirmed by us or our authorized after-sales service center, you can enjoy free repair or component replacement services. The repaired product or product with replaced components will continue to enjoy the warranty service during the remaining of the original product. If the remaining warranty service period is less than 3 months when warranty period the repair or component replacement occurs, the remaining warranty period will be extended to 3 months.
- 4). When return or replacement is required, the product should be in original condition in complete packaging. The main product itself as well as all the accessories should be without any damage, scratches or breakage. For repairs, new components become part of your product, and the components replaced should be returned to us.
- 5). For product hardware failures within scope of warranty, we will bear the logistics costs as well as other costs incurred by the warranty. For the failures or damages that are confirmed not in the coverage of warranty, unless otherwise specified at that time, you shall bear the round-trip freight (if any) and the risks in the transportation process.

5. Non-warranty coverage

Warranty will not be applicable under following occasions:

- 1). Failures or damages caused by improper physical or operating environment, force majeure, improper maintenance or storage, such as misuse, accident, modification, private dismantling, liquid intake, etc.
- 2). **Unauthorized organization or personnel dismantle or repair without our authorization.**
- 3). Discoloration, wear and consumption during use;
- 4). The relevant labels and marks of the products or parts are changed or removed, such as: the product information or serial number on the warranty certificate does not match the actual product, or has been altered;
- 5). Components with obvious damages by hard objects, scratching marks, broken corners, severe deformations and other breakages.
- 6). Warranty period expires.

6. Paid services

For product failures beyond the warranty period or outside the scope of the warranty service, we will provide paid professional repair services if it is confirmed within our service scope. With your knowledge and agreement, the old components replaced will be recycled when repaired. Unless expressly agreed otherwise, we will provide a 90-day warranty for the repaired or replaced components.

7. General terms

This service policy applies to the laws of mainland China (excluding its conflict laws). If any dispute arises due to the matters under this document and the friendly negotiation fails, it will be submitted to the People's Court with jurisdiction in Jiangcheng District, Yangjiang City for ruling.

WARRANTY CARD

Product Description	Name		Model#	
	Name		Phone	
User Information	Address			
	Address		Phone	
Retailer Information	Address/Website			
	Sale date		Invoice#	

For after-sales service needs, please contact the customer service department

After-sales service phone: 86 - 662 - 369 2722

Business hours: Mon. to Sun. 8:00-17:15

Manufacturer: BINOVDO MANUFACTURING CO., LTD.

Address: B9-3 Yiling Technology Industrial Park, Jiangcheng District, Yangjiang, Guangdong, China